

ecco combi

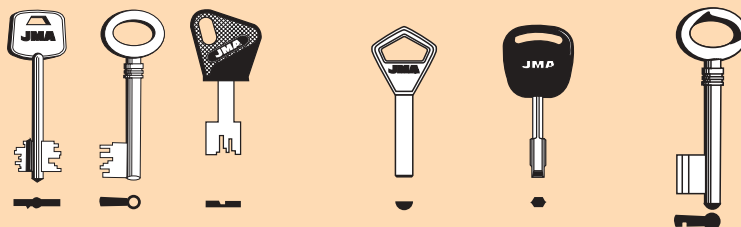

Máquina semiautomática versátil (en función de sus carros) para llaves de gorja de paletón y doble paletón, llaves tipo Abloy, y llaves tipo FORD (por código), y regata.





ECCO BIT

ECCO ABL

ECCO FD

ECCO RG



Características ECCO COMBI



| | ECCO BIT | ECCO RG | ECCO ABL | ECCO FD |
|---------------------------------|----------|---------|----------|---------|
| 1.- Palpador de paso controlado | ✓ | ✓ | ✓ | ✓ |
| 2.- Pantalla de protección | ✓ | ✓ | ✓ | ✓ |
| 3.- Cepillo | ✓ | ✓ | ✓ | ✓ |
| 4.- Micro - interruptor | ✓ | ✓ | ✓ | ✓ |
| 5.- Protección por fusibles | ✓ | ✓ | ✓ | ✓ |
| 6.- Carro FORD | | | | ✓ |
| 7.- Carro ABLOY | | | ✓ | |
| 8.- Carro RG | | ✓ | | |
| 9.- Carro BIT | ✓ | | | |

OPCIONES

ECCO BIT



ECCO ABLOY



ECCO FORD



ECCO RG



CODE

MOTOR

ECCO COMBI (Monofásico)
220 V. - 50 Hz. - 0,18 Kw. - 1.500 r.p.m.

ECCO COMBI-110 (Opcional Monofásico)
110 V. - 60 Hz. - 0,12 Kw. - 1.800 r.p.m.

DATOS TÉCNICOS

| | BIT | RG | ABL | FD |
|----------------------------------|--------------------|--------------------|---------------------|---------------------|
| MORDAZAS FORD | | | | EC105 |
| MORDAZAS ABLOY | | | EC66,EC67 | |
| MORDAZAS RG | | EC197, EC193 | | |
| MORDAZAS BIT* | EC86,EC85 | | | |
| FRESA | FP8 (63x1,4x16) | FP8 (63x1,4x16) | FP10 (63x2,4x16) | FP10 (63x2,4x16) |
| ANCHO | 520 mm. | | | |
| ALTO | 280 mm. | | | |
| PROFUNDIDAD | 245 mm. | | | |
| PESO | 16 Kg. | | | |
| * OPCIONAL: Mordaza Argentina | EC92, EC93 | | | |

ecco combi



Versatile semi automatic duplicating machine (depending on the carriage) for ABLOY, FORD and MORTICE KEYS.



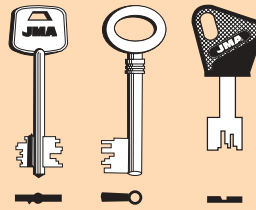

ECCO BIT



ECCO ABL

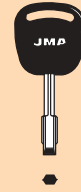

ECCO FD

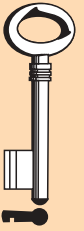

ECCO RG



ECCO COMBI Features



| | ECCO BIT | ECCO RG | ECCO ABL | ECCO FD |
|--|----------|---------|----------|---------|
| 1.- Tracer point with micrometric adjustment | ✓ | ✓ | ✓ | ✓ |
| 2.- Cutter guard | ✓ | ✓ | ✓ | ✓ |
| 3.- Brush | ✓ | ✓ | ✓ | ✓ |
| 4.- Micro - switch | ✓ | ✓ | ✓ | ✓ |
| 5.- Safety fuse fitted | ✓ | ✓ | ✓ | ✓ |
| 6.- FORD carriage | | | | ✓ |
| 7.- ABLOY carriage | | | ✓ | |
| 8.- RG carriage | | ✓ | | |
| 9.- BIT carriage | ✓ | | | |

OPTIONS

ECCO BIT

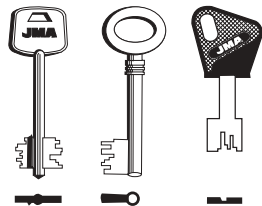

ECCO ABLOY

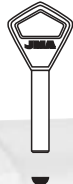

ECCO FORD



ECCO RG



CODE

MOTOR

ECCO COMBI (single phase)
220 V. - 50 Hz. - 0,18 Kw. - 1.500 r.p.m.

ECCO COMBI-110 (optional single phase)
110 V. - 60 Hz. - 0,12 Kw. - 1.800 r.p.m.

TECHNICAL DATA

| | BIT | RG | ABL | FD |
|------------------------------|--------------------|--------------------|---------------------|---------------------|
| FORD JAWS | | | | EC105 |
| ABLOY JAWS | | | EC66, EC67 | |
| RG JAWS | | EC197, EC193 | | |
| BIT* JAWS | EC86, EC85 | | | |
| CUTTER | FP8 (63x1,4x16) | FP8 (63x1,4x16) | FP10 (63x2,4x16) | FP10 (63x2,4x16) |
| WIDTH | 520 mm. | | | |
| HEIGHT | 280 mm. | | | |
| DEPTH | 245 mm. | | | |
| WEIGHT | 16 Kg. | | | |
| *OPTIONAL: ARGENTINA JAW. | EC92, EC93 | | | |